

# The Michigan Folk School at Staebler Farm County Park

7734 Plymouth Road, Superior Township, MI 48198  
www.MiFolkSchool.com  
registrar@MiFolkSchool.com  
(734) 436-8973



Staebler homestead site of the Michigan Folk School

In the fall of 2017, the Michigan Folk School began a partnership with Washtenaw County Parks & Recreation for the development of a folk school campus at Staebler Farm County Park. The farm was purchased by Washtenaw County in 2001 with the intent to provide unique recreational experiences, while preserving its agricultural legacy for future generations through educational programming.

Woodshop and Blacksmithing Studio

In the fall of 2017, Michigan Folk School entered into a lease agreement with Washtenaw County Parks and Recreation Commission for a few buildings in the historic farmhouse area on the south side of Staebler Farm. In 2018, Michigan Folk School successfully raised over \$80,000 to design and remodel a workshop used by Donald Staebler into a modern Wood Studio and Blacksmithing Shop. The Wood Studio was opened in January 2019 and the Blacksmithing Shop in December 2019.

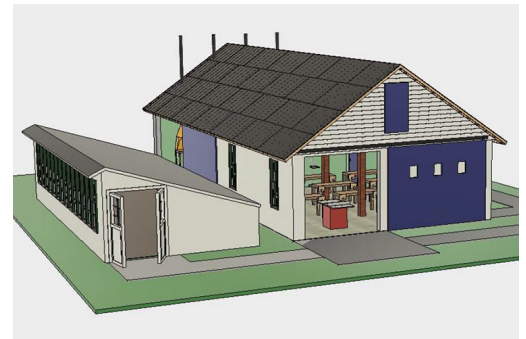

To get here from the Superior Township Hall (3040 N. Prospect Rd.):

Turn RIGHT (north) on Prospect Rd. (2.1 miles)  
Turn RIGHT (east) onto Plymouth Rd. (.4 mile)  
The school is on the right (south) side of the road